

schülke -+

mikrozyd® wipes

Your choice for surface disinfection against COVID-19

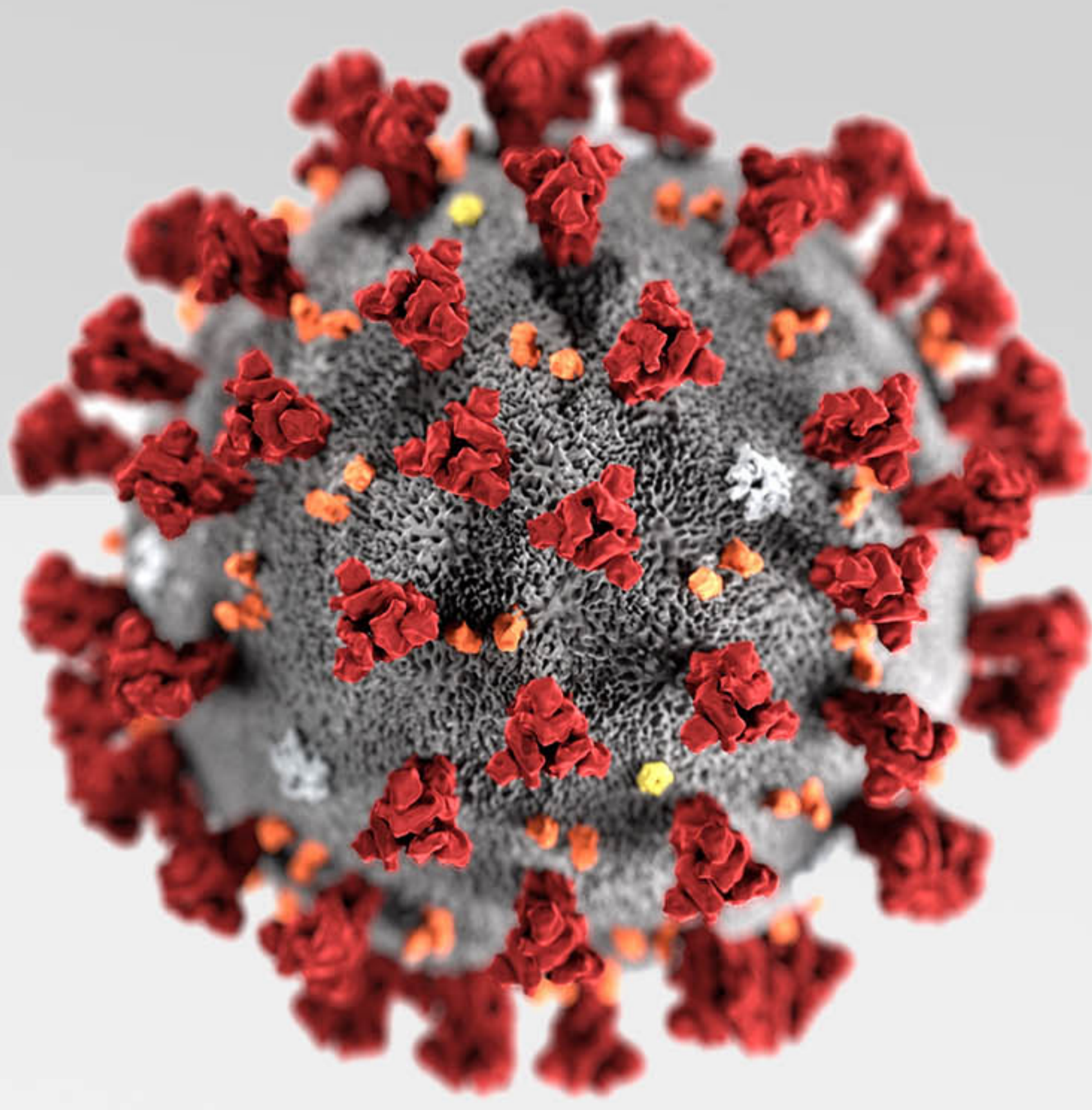



SARS-CoV-2

The Virus

- Enveloped virus
- Belongs to the coronavirus family (*Coronaviridae*)
- ~80% similarity to SARS-like coronaviruses in terms of genetic make-up
- Causes the Coronavirus Disease -19 (COVID-19) ¹
- Transmissible ²

Mode of Transmission

Close contact via droplets



Contamination of surroundings when the droplets containing the viruses lands on them (e.g. table) ³

Coronavirus can survive on inanimate surfaces from 2 hours to 9 days ^{4,5}

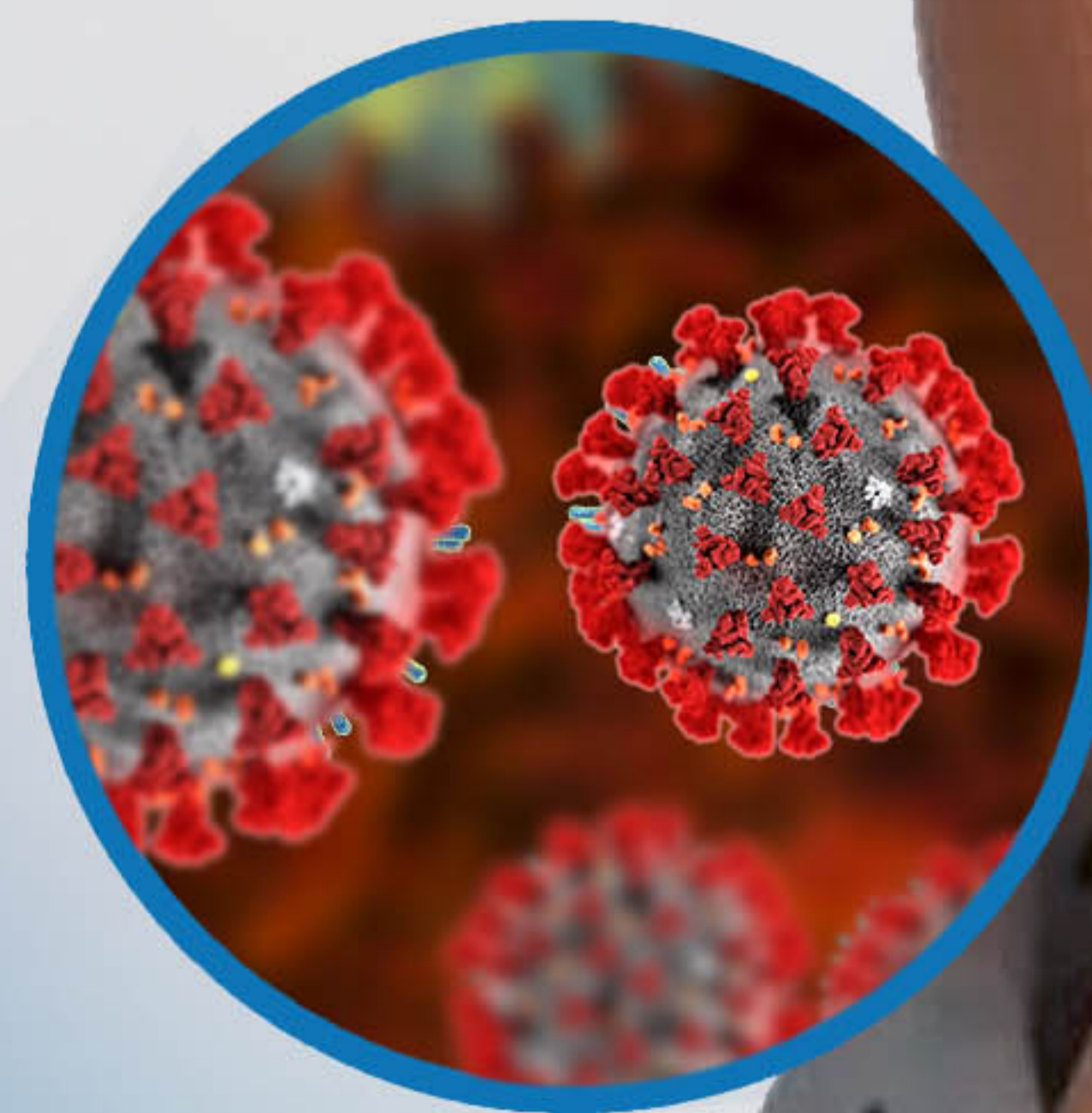

Indirect transmission

1. Wu et al (2020), 'A new coronavirus associated with human respiratory disease in China', Nature, doi:10.1038/s41586-020-2008-3
 2. Chen et al (2020), 'Pathogenicity and transmissibility of 2019-nCoV- A quick overview and comparison with other emerging viruses', Microbes Infect, doi:10.1016/j.micinf.2020.01.004
 3. Ong et al (2020), 'Air, surface environmental, and personal protective equipment contamination by SARS-CoV-2 by a symptomatic patient', JAMA, doi:10.1001/jama.2020.3227
 4. Kamf et al (2020), 'Persistence of coronaviruses on inanimate surfaces and its inactivation with biocidal agents', J Hosp Infect, doi:10.1016/j.jhin.2020.01.022
 5. van Doremalen et al (2020), 'Aerosol and Surface Stability of SARS-CoV-2 as Compared with SARS-CoV-1', N Engl J Med, doi:10.1056/NEJMc2004973



Environmental cleaning becomes critical to break transmission

The plus of Schülke mikrozid[®] range ready-to-use wipes

- Tested against enveloped viruses (EN14476)⁶

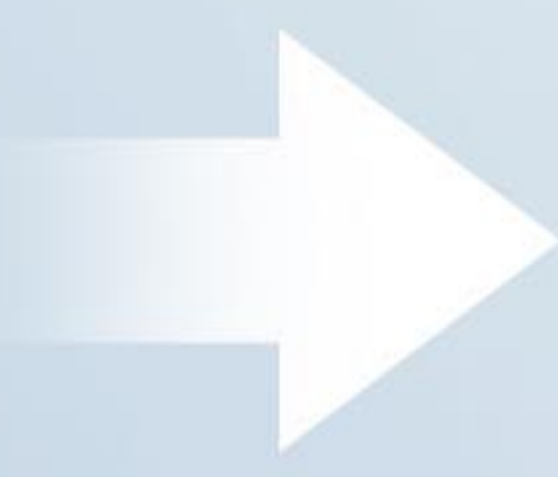

Suitable to be used in the high-risk or high-touch areas for COVID-19 outbreak

- High quality non-woven material

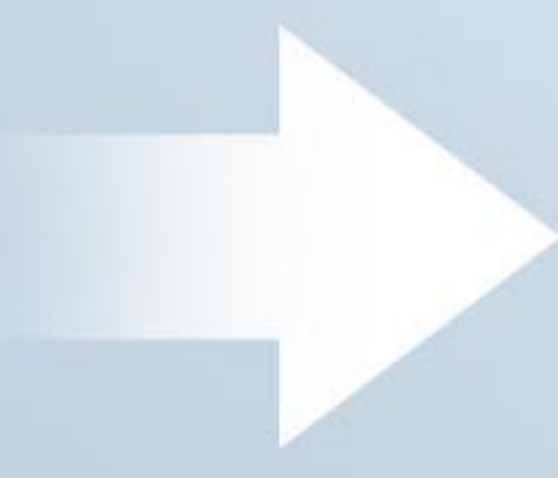

Tear-resistant and able to retain enough disinfectant liquid for efficient cleaning

- Wipes able to release enough liquid to contact surfaces

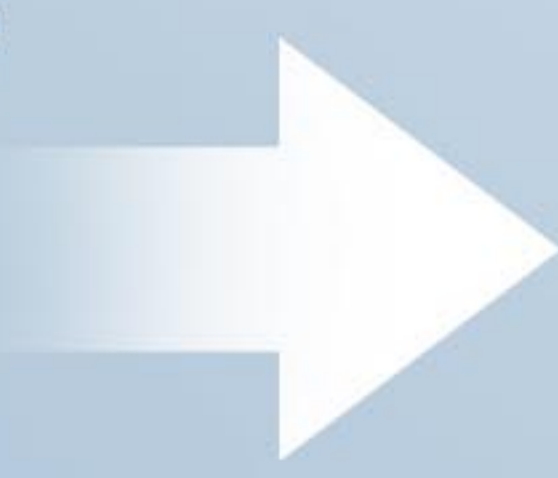

EN16615-tested (stringent Phase 2, step 2 test)

mikrozyd® AF wipes



- VIRUCIDAL** 30s
- BAC** 60s
- YEAST** 60s
- TB** 60s
- +** Alcohol

Material Compatibility | Rubber
Plastics
Metals

mikrozyd® sensitive wipes



- VIRUCIDAL** 60s
- BAC** 60s
- YEAST** 60s
- TB** -
- Alcohol-free

Material Compatibility | Rubber
Plastics
Metals
Leather
Plexi-glass

mikrozyd® universal wipes



- VIRUCIDAL** 15s
- BAC** 60s
- YEAST** 60s
- TB** 5 mins
- +** Alcohol

Material Compatibility | Rubber
Plastics
Metals
Leather
Plexi-glass

Product Features		Ready To Use Wipes		
		Mikrocid® AF	Mikrocid® Universal	
Composition	Active Ingredients	100g agent solution contains: - 25 g Ethanol (94 %) - 35 g Propan-1-ol	100g agent solution contains: - 12.6 g Ethanol (94%) - 17.4 g Propan-2-ol - < 5% anionic surfactants	
	Contains alcohol?	✓	✓	
Material Compatibility	Metals (e.g. Stainless steel, copper, brass)*	✓	✓	
	Rubbers (e.g. Natural rubber, silicone)*	✓	✓	
	Plastics (e.g. PE, PET, PS, PC)*	✓	✓	
	Plexi-glass (e.g. Acrylic)	✗	✓	
	Leather	✗	✓	
Antimicrobial Spectrum & Contact Time*	Bactericidal	1 min	Clean condition: 1 min Dirty condition: 2 mins	
	Yeasticidal (e.g. <i>Candida albicans</i> , <i>Candida auris</i>)	1 min	Clean condition: 1 min Dirty condition: 2 mins	
	Fungicidal (e.g. <i>Aspergillus</i> species)	2 mins	-	
	Mycobactericidal (e.g. <i>Mycobacterium terrae</i>)	1 min	5 mins	
	Enveloped virus (e.g. HIV, HBV, HCV, Coronavirus)	30 sec	15 sec	
	Non-enveloped virus (Rotavirus)	30 sec	15 sec	
	Non-enveloped virus (Adenovirus)	5 mins	15 mins	
	Non-enveloped virus (Norovirus)	1 min	30 sec	
	Surface Coverage	0.5m ² (Jumbo Tub)	0.7m ² (Premium Pack)	0.5m ² (Jumbo Tub)

Legend: ✓ - Yes, ✗ - No;

* For more information, please contact the relevant sales person or email to mail.sg@schuelke.com

How to use

Jumbo Tub

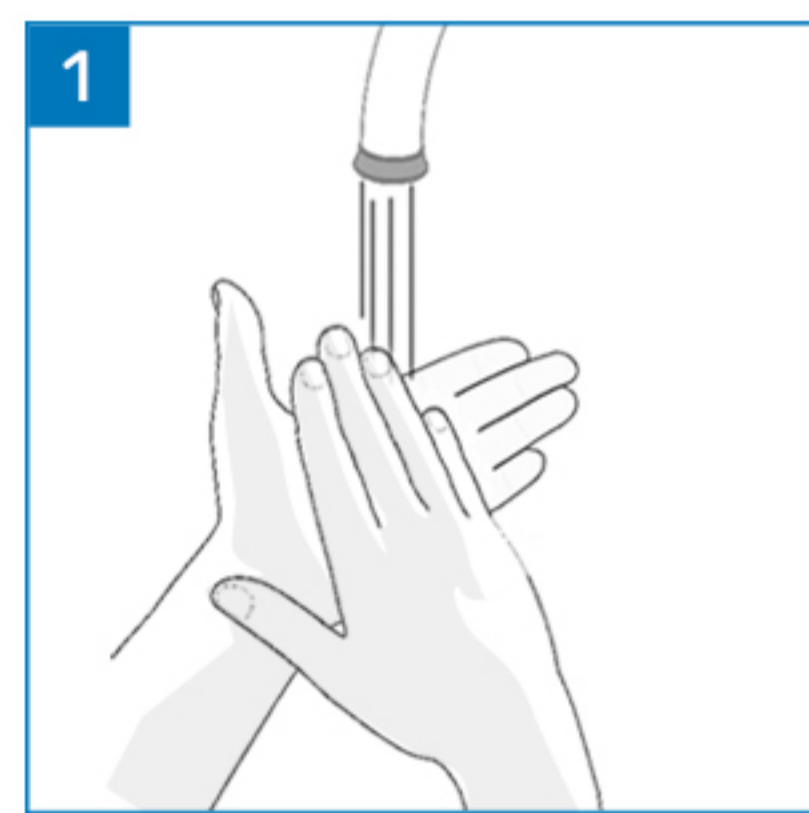

1 Wash hands thoroughly.

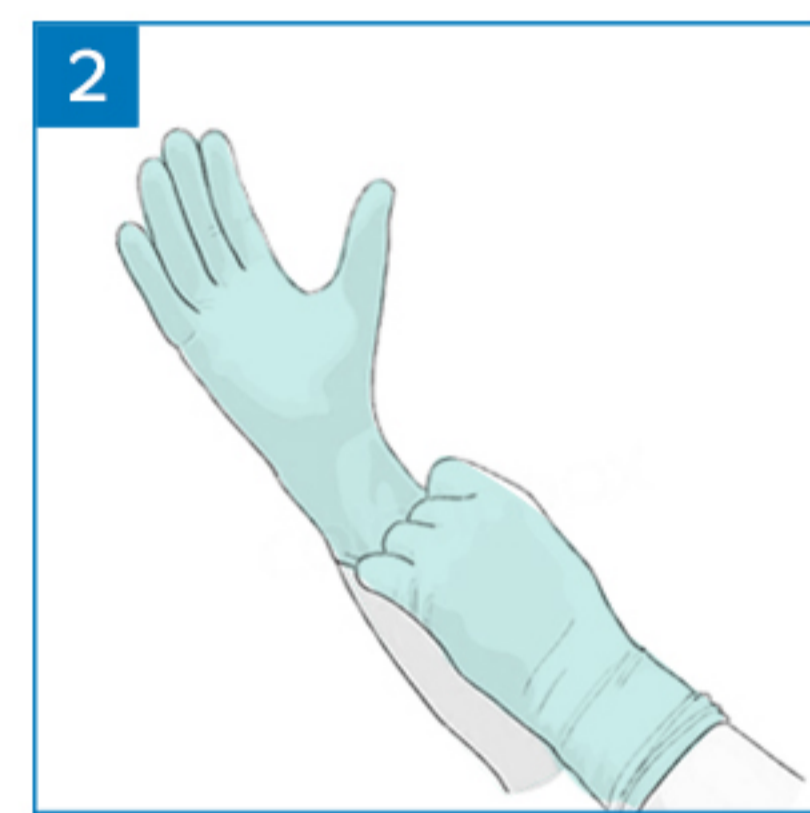

2 Put on gloves.

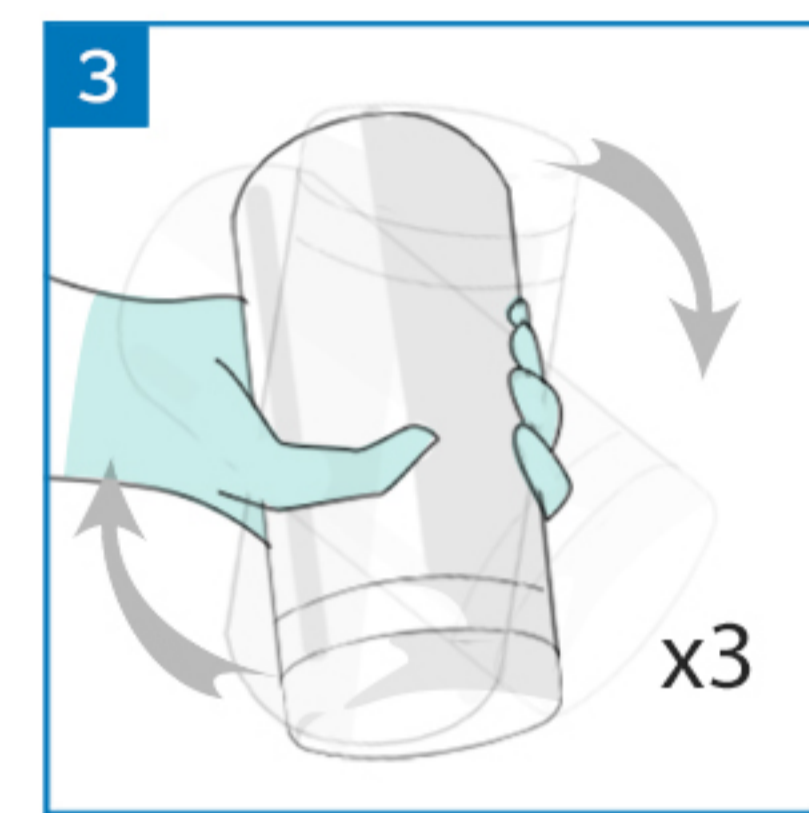

3 Invert the tub 3 times.



4 Open lid and pull out the wipes.



5 Wipe the surface with an "S" pattern.



6 Ensure complete wetting of the surface throughout the exposure time.

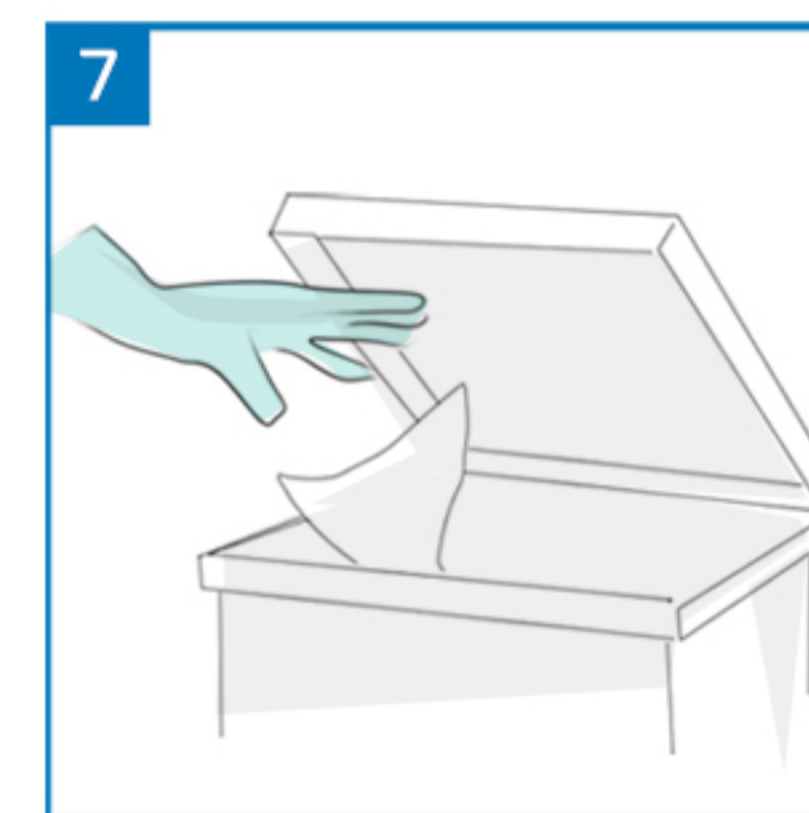

7 Dispose the used wipes.

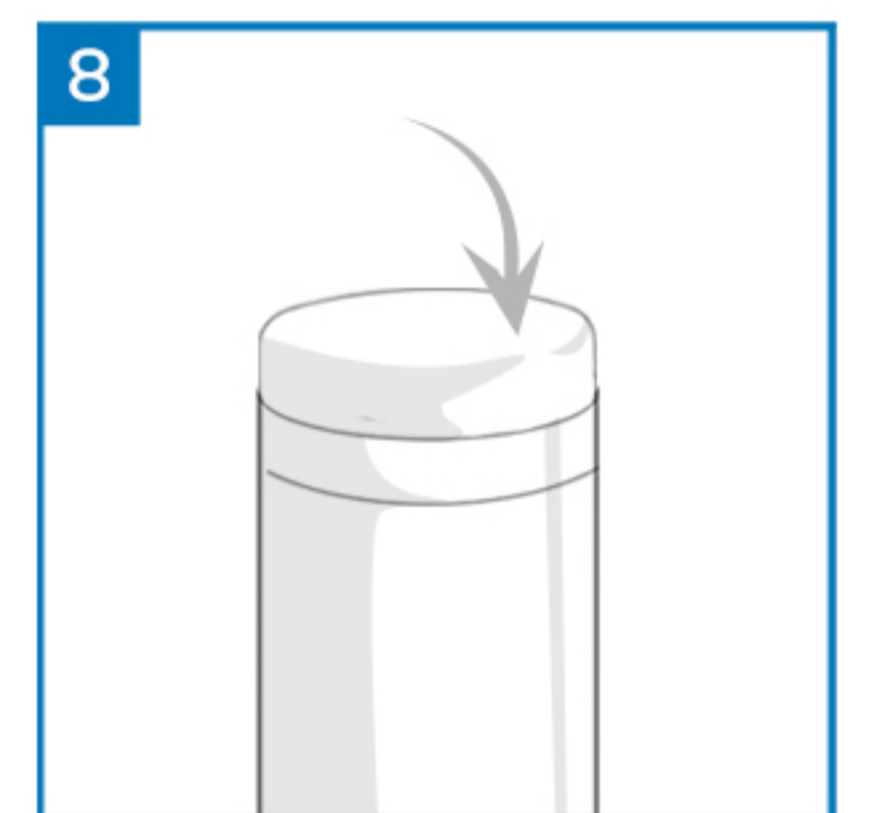

8 Make sure that the lid is securely closed.

Premium Pack

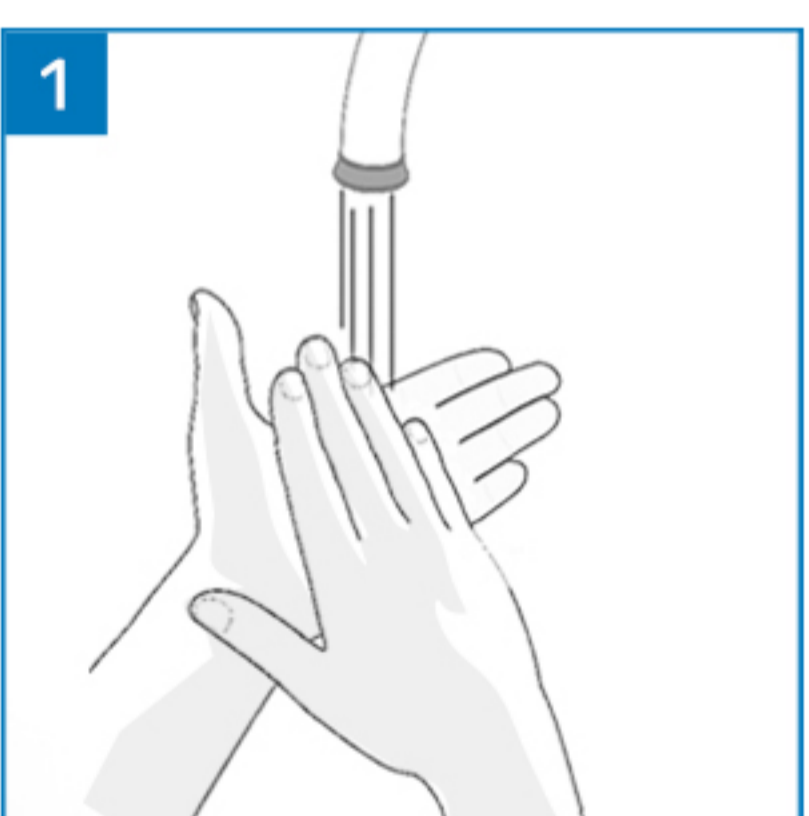

1 Wash hands thoroughly.

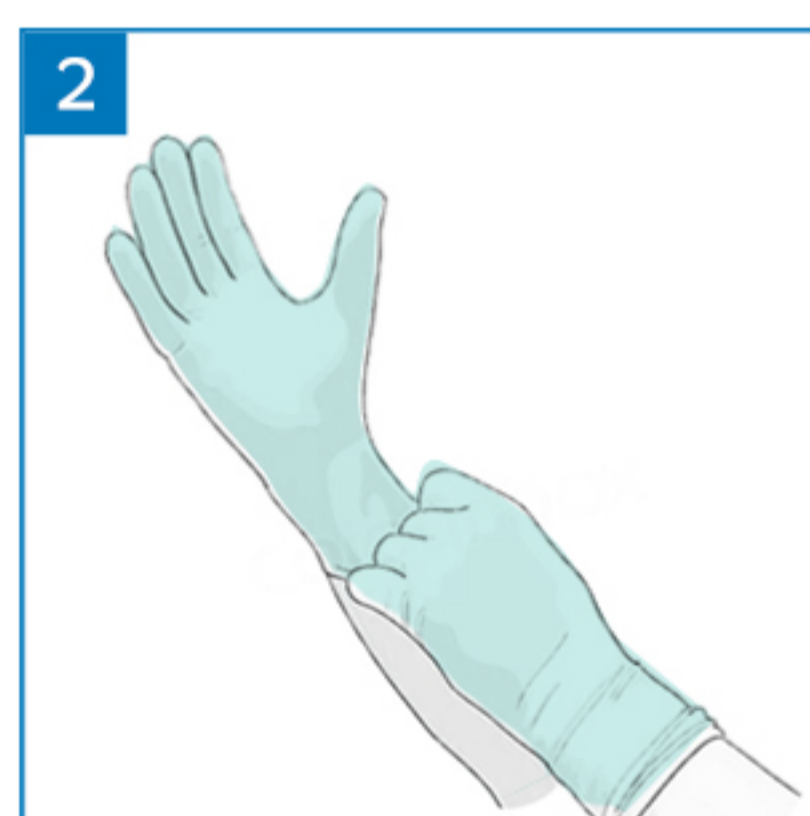

2 Put on gloves.



3 Open pack and pull out the wipes.

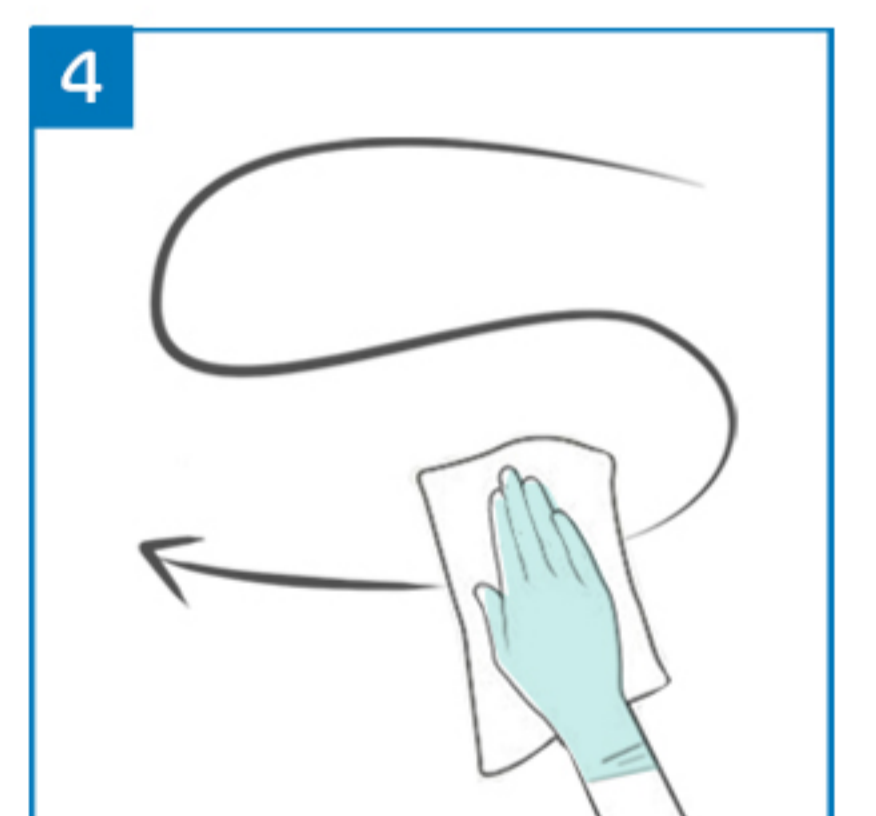

4 Wipe the surface with an "S" pattern.



5 Ensure complete wetting of the surface throughout the exposure time.

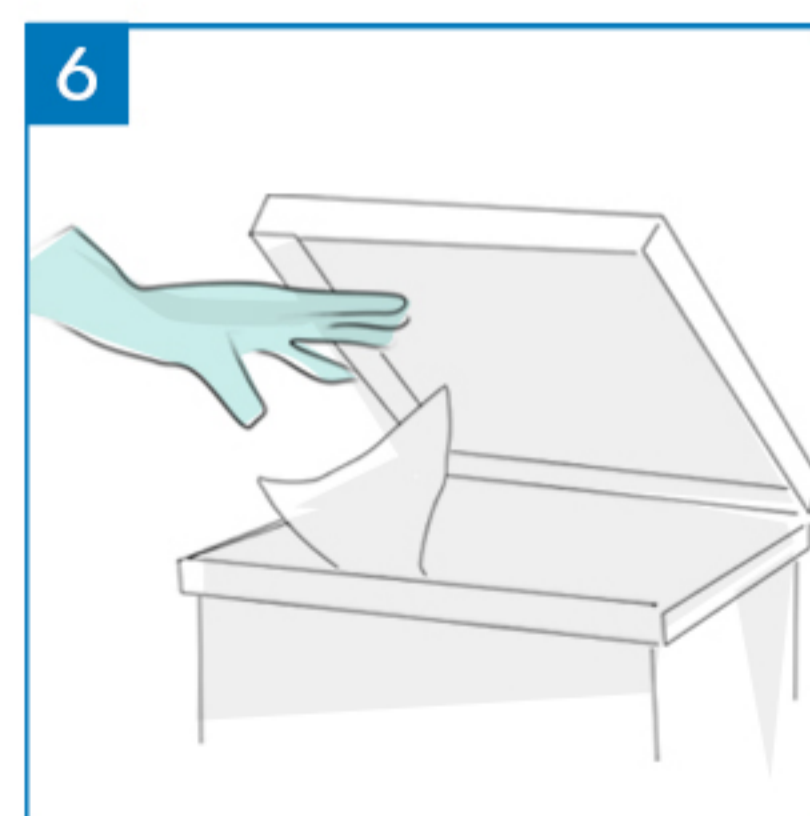

6 Dispose the used wipes.

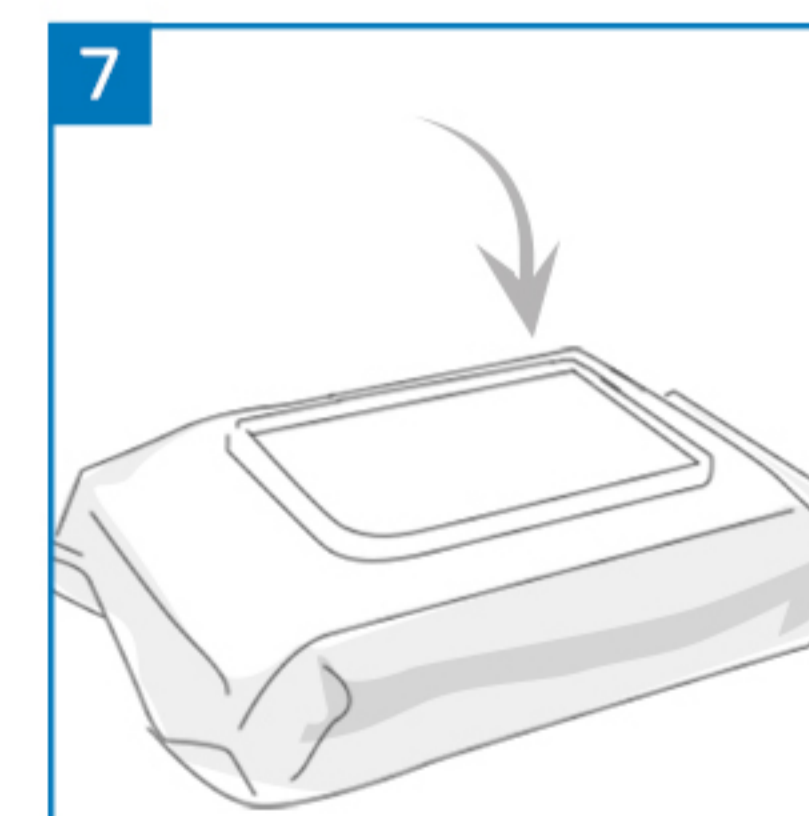

7 Make sure that the lid is securely closed.

Product Summary



**VIRU
CIDAL** 30s

BAC 60s

YEAST 60s

TB 60s

mikrozid® AF wipes | Jumbo |

Alcohol-based disinfectant wipes for fast disinfection of medical devices and other surfaces

Our plus

- Rapid virucidal effect (Coronavirus 30 secs)
- Good antimicrobial efficacy (Enveloped viruses incl. Coronavirus, HBV, HIV, HCV), bacteria incl. TB, yeasts))
- Good material compatibility
- Rapid surface disinfection, leaving no streaks
- Color and perfume-free



Pack size

Carton with 10 x 200 wipes *Jumbo*



**VIRU
CIDAL** 60s

BAC 60s

YEAST 60s

TB -

mikrozid® sensitive wipes | Jumbo |

Alcohol-free disinfectant wipes for fast disinfection of medical devices and other surfaces

Our plus

- Rapid virucidal effect (Coronavirus 60 secs)
- Good antimicrobial efficacy (Enveloped viruses incl. Coronavirus, HBV, HIV, HCV), bacteria, yeasts))
- Excellent material compatibility
- Suitable usage on alcohol sensitive surfaces
- Color and perfume-free



Pack size

Carton with 10 x 200 wipes *Jumbo*



**VIRU
CIDAL** 15s

BAC 60s

YEAST 60s

TB 5 mins

mikrozid® universal wipes | Premium Pack |

Low-alcohol-based rapid disinfectant wipes for medical devices and other surfaces

Our plus

- Rapid virucidal effect (Coronavirus 15 secs)
- Good antimicrobial efficacy (Enveloped viruses incl. Coronavirus, HBV, HIV, HCV), bacteria incl. TB, yeasts))
- Excellent material compatibility incl. surfaces of electronic devices (e.g. tablet)
- High quality dermatologically tested wipes
- Color and perfume-free



Pack size

Carton with 6 x 100 wipes *Premium*



schülke worldwide:

Australia

Schulke Australia Pty Ltd
Macquarie Park NSW 2113
Phone +61 2 8875 9300
Fax +61 2 8875 9301

Austria

Schülke & Mayr Ges.m.b.H.
1070 Vienna
Phone +43 1 523 25 01 0
Fax +43 1 523 25 01 60

Brazil

Vic Pharma Indústria e
Comércio Ltda.
Taquaratinga/SP – CEP
15900-000
Phone +16 3253 8100
Fax +16 3253 8101

China

Shanghai Representative
Office
Shanghai 200041
Phone +86 21 62 17 29 95
Fax +86 21 62 17 29 97

Czech Republic

Schulke CZ, s.r.o.
73581 Bohumín
Phone +420 558 320 260
Fax +420 558 320 261

France

Schülke France SARL
92806 Puteaux, Paris La Défense
Phone +33 1 42 91 42 42
Fax +33 1 42 91 42 88

India

Schulke India Pvt. Ltd.
New Delhi 110044
Phone +91 11 30796000
Fax +91 11 42595051

Italy

Schülke & Mayr Italia S.r.l.
20158 Milano
Phone +39 02 40 26 590
Fax +39 02 40 26 609

Malaysia

Schülke & Mayr (Asia) Sdn Bhd.
47301 Petaling Jaya, Selangor
Phone +60 3 78 85 80 20
Fax +60 3 78 85 80 21

Netherlands

Schülke & Mayr Benelux B.V.
2031 CC Haarlem
Phone +31 23 535 26 34
Fax +31 23 536 79 70

New Zealand

Schulke New Zealand Limited
Auckland 1010
Phone +61 2 8875 9300
Fax +61 2 8875 9301

Poland

Schulke Polska Sp. z o.o.
02-305 Warszawa
Phone +48 22 11 60 700
Fax +48 22 11 60 701

Russia

Moscow Representative Office
123001, Moscow
Phone +7 499 270 58 75
Fax +7 962 902 77 15

Singapore

Schülke & Mayr (Asia) Pte. Ltd.
Singapore 159410
Phone +65 62 57 23 88
Fax +65 62 57 93 88

Slovakia

Schulke SK, s.r.o.
97101 Prievidza
Phone +421 46 549 45 87
Fax +420 558 320 261

Switzerland

Schülke & Mayr AG
8003 Zurich
Phone +41 44 466 55 44
Fax +41 44 466 55 33

United Kingdom

Schülke & Mayr UK Ltd.
Sheffield S9 1AT
Phone +44 114 254 35 00
Fax +44 114 254 35 01

... plus our international distributors

-  youtube.com/schuelkeChannel
-  facebook.com/SchulkeAsia
-  instagram.com/Schulke_Asia
-  linkedin.com/company/schulke-asia/

Schülke & Mayr (Asia) Pte. Ltd.

Singapore 159410
Phone | +65-6257-2388
Fax | +65-6257-9388

A company of the  Air Liquide
Air Liquide Group HEALTHCARE

Distributed by:

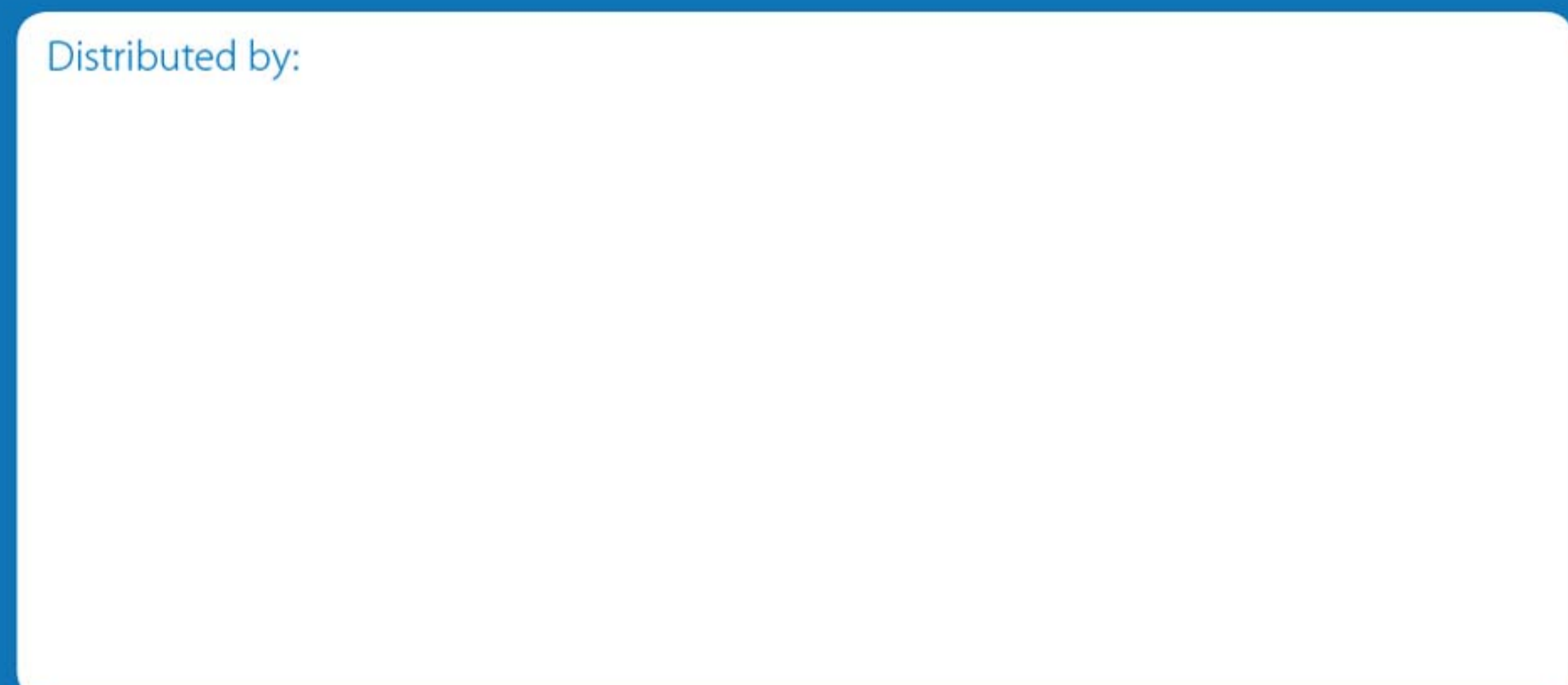

B1901.03.20-A-01

This product information is not automatically updated.